

# WKE45 SUPER COBALT HSS TOOL BITS

RECTANGULAR		
B A Size	L Overall Length	Net Price Each
1/8x5/8"	6"	28.12
3/16x5/16	4	18.89
1/4x3/8	2½	17.41
1/4x3/8	4	20.08
1/4x1/2	3	17.70
1/4x1/2	4	20.48
1/4x1/2	6	33.42
1/4x3/4	5	33.12
1/4x3/4	6	40.06
1/4x1	6	55.08
5/16x7/16	4	26.17
5/16x1/2	3	19.45
5/16x1/2	6	38.94
5/16x3/4	5	68.75
5/16x1	6	69.15
3/8x1/2	3	28.59
3/8x1/2	4	28.57
3/8x1/2	6	41.06
3/8x5/8	4	30.74
3/8x5/8	5	36.39
3/8x5/8	6	39.98
3/8x3/4	4	34.62
3/8x3/4	5	40.66
3/8x3/4	6	54.42
3/8x1	6	100.53
1/2x3/4	4	40.48
1/2x3/4	5	48.66
1/2x3/4	6	53.66
1/2x1	7	87.49
1/2x1¼	7	138.49
1/2x1½	7	180.72
5/8x3/4	5	75.27
5/8x7/8	6	136.60
5/8x1	7	137.78
5/8x1¼	7	177.81
3/4x1	6	139.20
3/4x1¼	6	164.15

METRIC RECTANGULAR		
B A Size	L Overall Length	Net Price Each
3x12mm	90mm	14.68
3x12	200	33.65
4x10	100	17.48
4x10	120	22.52
4x10	200	35.12
4x16	160	37.53
4x16	200	40.94
4x20	200	47.43
5x12	90	17.93
5x20	200	52.94
6x8	70	14.31
6x10	200	38.00
6x12	200	46.83
6x14	140	32.30
6x14	200	50.45
6x16	200	50.38
6x18	140	41.52
6x20	200	56.96
6x25	200	79.28
8x12	160	38.78
8x12	200	47.02
8x16	140	41.13
8x16	160	47.12
8x16	200	56.90
8x20	200	73.02
8x32	200	119.97
10x12	200	56.05
10x14	80	35.20
10x14	200	61.44
10x16	160	57.90
10x16	200	66.67
10x20	160	77.08
10x20	200	83.37
10x25	200	95.56
10x40	200	171.97
12x16	200	85.85
12x20	160	81.24
12x20	200	102.78
12x25	200	103.93
12x30	200	134.11
14x20	200	99.91
14x25	200	133.93
16x20	200	105.28
16x25	200	143.06
16x32	160	145.18
20x25	200	161.16

SQUARE		
Size Square	L Overall Length	Net Price Each
3/16"	2½"	6.75
3/16	4	11.24
1/4	2½	8.26
1/4	4	14.09
1/4	6	20.09
1/4	8	26.20
5/16	2½	9.16
5/16	3	11.80
5/16	4	16.12
5/16	6	22.79
5/16	8	35.68
3/8	3	15.37
3/8	4	17.38
3/8	6	26.02
3/8	8	42.05
7/16	3½	25.17
1/2	4	25.52
1/2	6	36.30
1/2	8	60.42
5/8	4½	44.65
5/8	6	78.40
5/8	8	93.09
3/4	5	63.69
3/4	6	76.48
3/4	8	131.41
1	5½	158.22
1	8	234.55

METRIC SQUARE		
Size Square	L Overall Length	Net Price Each
4mm	63mm	6.89
4	100	11.95
5	63	6.64
5	160	22.32
6	63	8.60
6	100	14.24
6	160	23.43
6	200	24.60
7	200	26.31
8	63	13.08
8	100	21.63
8	160	22.52
8	200	30.78
10	125	26.84
10	160	34.99
10	200	36.49
12	100	31.87
12	160	35.29
12	200	49.49
14	100	41.79
14	160	58.35
14	200	75.03
16	100	55.69
16	160	86.85
16	200	93.93
18	200	120.11
20	160	113.80
20	200	141.54
25	200	223.77

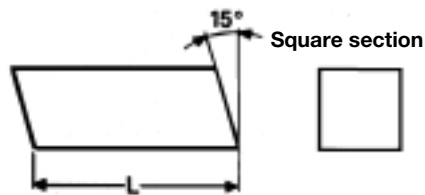

**All Toolbits can be custom ground to meet your requirements**

WKE45 TYPICAL ANALYSIS					
C	Cr	Mo	W	V	Co
1.40	4.2	3.5	9.0	3.5	11.0

SEE PAGE 13 FOR  
WKE45 ROUND BLANKS

## WILLIAM T. HUTCHINSON CO.

TOLL FREE 1-800-544-7934 • 453 LEHIGH AVENUE • UNION, NEW JERSEY 07083-7926

# SQUARE & FLAT FORM TOOL BITS

**Square - Ground  
High Speed Tool Bits**  
Tolerance on Width and  
Thickness  $\pm.002$   
Ends Beveled  $10^\circ$



SIZE	M2	M3	M42	T15 *	M34	T15PM
	R/C 64.5-66	R/C 65-66.5	R/C 67-69	R/C 65-67	R/C 65-67	R/C 65-67
1/8 sq. x 2 1/2"	9.40	9.93	9.70	11.94	9.62	12.93
3/16 sq. x 2 1/2"	5.03	5.32	5.41	6.80	5.40	7.28
1/4 sq. x 2 1/2"	5.44	5.80	6.11	7.59	6.08	8.04
5/16 sq. x 2 1/2"	6.03	6.49	7.04	8.96	7.02	9.45
3/8 sq. x 3"	7.99	8.65	9.80	12.42	9.70	12.97
7/16 sq. x 3 1/2"	11.15	11.02	12.68	16.51	12.83	17.06
1/2 sq. x 4"	13.79	15.28	18.19	23.49	17.94	24.05
5/8 sq. x 4 1/2"	20.77	23.27	28.08	36.85	27.63	37.54
3/4 sq. x 5"	32.77	36.69	44.76	58.22	44.07	59.41
7/8 sq. x 6" *	52.25	58.65	71.25	94.76	70.13	94.76
1 sq. x 7"	76.13	85.56	112.56	137.82	103.95	140.71
1-1/8 sq. x 8" *	110.26	125.17	158.12	202.31	155.59	—
1-1/4 sq. x 9" *	153.08	172.30	213.20	276.32	209.78	—

SIZE	M2	M3*	M42	T15	M34*
	R/C 64.5-66	R/C 65-66.5	R/C 67-69	R/C 65-67	R/C 65-67
1/4" x 3/8" x 2-1/2"	7.36	—	—	—	8.51
x 3/8" x 3"	8.87	9.08	—	12.28	—
x 1/2" x 3"	9.48	—	—	—	—
x 1/2" x 4"	11.73	12.24	14.37	17.21	14.23
x 1/2" x 6"	17.52	—	—	—	21.30
x 3/4" x 5"	17.04	17.90	21.67	26.20	—
x 3/4" x 6"	—	—	22.99	—	—
x 1" x 6"	26.98	28.40	34.46	41.76	—
5/16" x 7/16" x 3"	10.11	—	—	—	—
x 7/16" x 3-1/2"	11.78	12.21	14.25	16.96	—
x 1/2" x 3"	11.52	—	—	—	13.74
x 5/8" x 4"	15.51	16.21	19.41	23.32	—
3/8" x 1/2" x 3"	11.18	—	—	—	14.32
x 1/2" x 4"	14.97	15.62	18.72	22.65	18.52
x 1/2" x 6"	22.35	—	—	—	27.66
x 5/8" x 4"	16.28	—	—	—	20.60
x 5/8" x 4-1/2"	18.31	19.23	23.49	28.59	—
x 5/8" x 5"	—	—	—	—	25.72
x 5/8" x 6"	24.44	—	27.46	—	31.09
x 3/4" x 4"	18.39	—	—	—	23.56
x 3/4" x 5"	23.00	24.24	29.67	36.24	—
x 3/4" x 6"	27.57	—	34.82	—	35.42
x 1" x 6"	34.09	36.24	45.12	55.16	—
1/2" x 5/8" x 4-1/2"	20.36	21.65	27.35	33.47	—
x 3/4" x 4"	22.92	—	—	—	27.13
x 3/4" x 5"	25.64	27.52	33.96	42.70	—
x 3/4" x 6"	30.77	—	39.76	—	40.15
x 1" x 7"	52.23	55.63	67.74	84.51	—
x 1" x 8"	59.63	—	—	—	76.31
5/8" x 3/4" x 5"	34.38	36.48	45.82	55.91	45.23
x 7/8" x 6"	47.83	50.78	64.11	78.10	63.24
x 1" x 7"	63.73	67.62	84.54	103.37	—
x 1-1/4" x 7"	79.60	84.46	105.57	128.94	—
x 1-1/2" x 7"	93.06	98.90	123.78	151.72	—

**\* AVAILABLE UNTIL  
STOCK IS EXHAUSTED**

**Flat Form - Ground  
High Speed Tool Bits**  
Tolerance on Width and  
Thickness  $\pm.002$   
Square Ends

**Additional Sizes and Materials  
Available — Call for Price  
and Delivery**

**All Toolbits can be custom  
ground to meet your  
requirements**

**WILLIAM T. HUTCHINSON CO.**

TOLL FREE 1-800-544-7934 • (908) 688-0533 • FAX (908) 688-8296 • ESTABLISHED 1927

[www.hssblanks.com](http://www.hssblanks.com)

# SQUARE & FLAT FORM TOOL BITS

SIZE	M2	M3*	M42	T15	M34*
	R/C 64.5-66	R/C 65-66.5	R/C 67-69	R/C 65-67	R/C 65-67
3/4" x 1" x 6"	63.46	—	—	—	84.63
x 1" x 7"	74.07	79.10	99.19	121.58	—
x 1-1/4" x 7"	93.06	98.90	123.69	151.78	—
x 1-1/2" x 7"	103.63	110.65	140.20	172.56	—
7/8" x 1-1/8" x 7"	98.01	—	—	—	—
x 1-1/4" x 7"	108.92	114.82	146.41	177.12	—
1" x 1-1/4" x 6"	98.73	105.18	133.83	165.03	—

**Flat Form - Ground  
High Speed Tool Bits**  
Tolerance on Width and  
Thickness  $\pm .002$   
**Square Ends**

\* AVAILABLE UNTIL  
STOCK IS EXHAUSTED

**Thin Flat Form - Ground  
High Speed Tool Bits**  
Tolerance on Width and  
Thickness  $+.002$   
 $-.000$   
**Square Ends**

SIZE	M2	M42	T15PM
	R/C 62-64	R/C 66-68	R/C 65-67
1/16" x 1/2" x 6"	9.49	14.61	11.93
x 3/4" x 6"	10.34	16.36	13.36
x 1" x 6"	12.14	18.39	16.29
3/32" x 1/2" x 6"	10.76	13.97	18.50
x 3/4" x 6"	11.89	15.79	21.64
x 1" x 6"	14.21	18.74	25.43
1/8" x 1/2" x 6"	13.44	20.50	18.64
x 3/4" x 6"	14.94	23.43	22.43
x 1" x 6"	17.68	28.17	26.36
5/32" x 1/2" x 6"	15.43	19.57	20.64
x 3/4" x 6"	17.50	22.50	24.43
x 1" x 6"	20.79	28.03	29.71
3/16" x 1/2" x 6"	13.71	18.00	20.29
x 3/4" x 6"	15.79	21.07	24.07
x 1" x 6"	19.10	25.67	29.50
1/4" x 1/2" x 6"	18.87	20.14	23.21
x 3/4" x 6"	22.13	24.01	29.86
x 1" x 6"	26.29	28.93	36.86

**T15 & T15PM  
Long High Speed Tool Bits**  
R/C 65-67

SIZE	T15*	T15PM
3/16 x sq. x 6"	16.29	17.45
1/4 x sq. x 6"	18.16	19.30
1/4 x sq. x 8"	—	25.73
5/16 x sq. x 6"	21.52	22.67
3/8 x sq. x 6"	24.79	25.91
3/8 x sq. x 8"	—	34.55
7/16 x sq. x 6"	28.23	29.27
1/2 x sq. x 6"	35.18	36.07
1/2 x sq. x 8"	—	48.09
5/8 x sq. x 6"	49.06	50.04
5/8 x sq. x 8"	—	66.74

**Tolerance on Width  
and Thickness  $\pm .002$**   
**Ends Beveled 10°**

**Typical Analysis of High Speed Steel  
Tool Bit Materials**

	C	Cr	Mo	W	V	Co
<b>M2</b>	.85	4.15	5.00	6.30	1.85	—
<b>M3</b>	1.20	4.10	5.00	6.00	3.00	—
<b>M42</b>	1.10	3.75	9.50	1.50	1.15	8.25
<b>T15 &amp; T15PM</b>	1.57	4.00	—	12.25	5.00	5.00
<b>M34</b>	.90	3.75	8.00	1.50	2.05	8.25

## WILLIAM T. HUTCHINSON CO.

TOLL FREE 1-800-544-7934 • 453 LEHIGH AVENUE • UNION, NEW JERSEY 07083-7926

# CARBIDE BLANKS STYLE 1000 & 2000

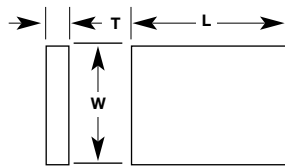

Style 1000

C-2 GRADE  
PREMIUM MEDIUM  
GRAIN CARBIDE  
WITH 6-8% COBALT

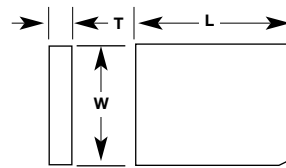

Style 2000

Dimensions				Blank Number	Price	Blank Number	Price
T	W	L	R	STYLE 1000	1 - 249 pcs.	STYLE 2000	1 - 249 pcs.
1/16	1/8	5/8	1/8	1010	.68	2010	.68
1/16	3/16	1/4	1/8	1020	.63	2020	.63
1/16	1/4	5/16	1/8	1030	.68	2030	.68
3/32	3/16	5/16	1/8	1040	.70	2040	.70
3/32	3/16	1/2	1/8	1050	.85	2050	.85
3/32	1/4	3/8	1/8	1060	.85	2060	.85
3/32	1/4	1/2	1/8	1070	.93	2070	.93
3/32	5/16	3/8	3/16	1080	.85	2080	.85
3/32	3/8	3/8	3/16	1090	.87	2090	.90
3/32	3/8	1/2	3/16	1100	1.06	2100	1.06
3/32	7/16	1/2	1/4	1105	1.16	2105	1.16
1/8	3/16	3/4	1/8	1110	1.16	2110	1.17
1/8	1/4	1/2	1/8	1120	.97	2120	1.04
1/8	1/4	5/8	1/8	1130	1.16	2130	1.14
1/8	1/4	3/4	1/8	1140	1.24	2140	1.44
1/8	5/16	7/16	3/16	1150	1.16	2150	1.22
1/8	5/16	1/2	3/16	1160	1.13	2160	1.24
1/8	5/16	5/8	3/16	1170	1.32	2170	1.32
1/8	3/8	1/2	3/16	1180	1.30	2180	1.32
1/8	3/8	3/4	3/16	1190	1.82	2190	1.82
1/8	1/2	1/2	1/4	1200	1.66	2200	1.66
1/8	1/2	3/4	1/4	1210	2.41	2210	2.41
1/8	3/4	3/4	1/4	1215	3.62	2215	3.62
5/32	3/8	9/16	3/16	1220	2.11	2220	2.11
5/32	3/8	3/4	3/16	1230	2.26	2230	2.26
5/32	5/8	5/8	1/4	1240	3.09	2240	3.09
3/16	5/16	7/16	3/16	1250	1.52	2250	1.37
3/16	5/16	5/8	3/16	1260	1.86	2260	1.86
3/16	3/8	1/2	3/16	1270	1.78	2270	1.84
3/16	3/8	5/8	3/16	1280	2.23	2280	2.23
3/16	3/8	3/4	3/16	1290	2.62	2290	2.62
3/16	7/16	5/8	1/4	1300	2.54	2300	2.54
3/16	7/16	13/16	1/4	1310	3.28	2310	3.28
3/16	1/2	1/2	1/4	1320	2.33	2320	2.33
3/16	1/2	3/4	1/4	1330	3.49	2330	3.49
3/16	3/4	3/4	1/4	1340	5.20	2340	5.20

ALL STYLE 1000, 2000, STB & STBL SERIES  
BLANKS LISTED ARE UNGROUND

GROUND BLANKS TO YOUR SPECIFICATIONS  
ARE AVAILABLE • PRICES UPON REQUEST

THICKNESS: MINIMUM GRIND STOCK  
1/16" TO 5/16" +0.04" - +0.015" ON ALL DIMENSIONS  
3/8" TO 1" +0.06" - +0.020" ON ALL DIMENSIONS

C-5 GRADE PREMIUM MEDIUM GRAIN  
CARBIDE WITH 10% COBALT ALSO AVAILABLE

## WILLIAM T. HUTCHINSON CO.

TOLL FREE 1-800-544-7934 • (908) 688-0533 • FAX (908) 688-8296 • ESTABLISHED 1927

# CARBIDE BLANKS STYLE STB - STBL

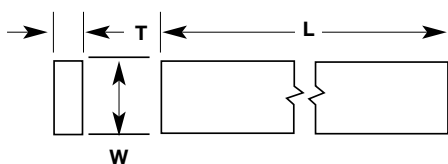

Style STB-STBL

Dimensions			Blank Number	Price ea.
T	W	L		
1/32	1/16	1	STB-12	.82
1/32	1/16	1-1/2	STB-12A	.98
3/64	3/32	13/16	STB-13A	1.05
3/64	3/32	1	STB-13	1.16
1/16	1/16	6	STB-22L	6.09
1/16	1/8	1	STB-24A	1.10
1/16	1/8	1-1/4	STB-24C	1.34
1/16	1/8	1-1/2	STB-24D	1.39
1/16	1/8	3	STB-24B	2.39
1/16	1/8	6	STB-24L	5.16
1/16	3/16	1	STB-26A	1.13
1/16	3/16	3	STB-26C	2.58
1/16	3/16	6	STB-26L	5.60
1/16	1/4	1	STB-28A	1.39
1/16	1/4	1-1/4	STB-28B	1.68
1/16	1/4	3	STB-28D	4.00
1/16	1/4	6	STB-28L	7.99
1/16	5/16	6	STB-210L	17.87
1/16	3/8	6	STB-212L	20.26
1/16	1/2	6	STB-216L	23.69
1/16	5/8	6	STB-220L	33.61
1/16	3/4	6	STB-224L	37.81
1/16	1	6	STB-232L	43.34
5/64	1/8	1-1/8	STB-14	1.46
3/32	1/8	5	STB-34	5.01
3/32	1/8	8	STB-34L	6.74
3/32	3/16	1-1/8	STB-36	1.30
3/32	3/16	1-1/4	STB-36A	1.30
3/32	3/16	8	STB-36L	8.19
3/32	1/4	1	STB-38A	1.27
3/32	1/4	1-1/2	STB-38B	2.29
3/32	1/4	5	STB-38D	6.81
3/32	1/4	8	STB-38L	11.64
3/32	5/16	2	STB-310A	3.60
3/32	5/16	3	STB-310B	5.64
3/32	5/16	5	STB-310C	8.19
3/32	5/16	8	STB-310L	12.74
3/32	3/8	5	STB-312	9.64
3/32	3/8	8	STB-312L	13.64
3/32	1/2	8	STB-316L	18.91
3/32	5/8	8	STB-320L	23.20
1/8	1/8	12	STB-44L	11.45

Dimensions			Blank Number	Price ea.
T	W	L		
1/8	3/16	6	STB-46	8.30
1/8	3/16	12	STB-46L	17.04
1/8	1/4	1	STB-48A	1.69
1/8	1/4	1-1/4	STB-48B	1.89
1/8	1/4	1-1/2	STB-48F	2.27
1/8	1/4	2-1/4	STB-48C	3.40
1/8	1/4	3	STB-48D	4.53
1/8	1/4	6	STB-48E	9.06
1/8	1/4	12	STB-48L	18.43
1/8	5/16	1-1/2	STB-410A	2.83
1/8	5/16	3	STB-410B	6.00
1/8	5/16	6	STB-410	11.32
1/8	3/8	1	STB-412D	2.27
1/8	3/8	2	STB-412A	4.53
1/8	3/8	3	STB-412B	6.79
1/8	3/8	6	STB-412C	13.58
1/8	3/8	12	STB-412L	27.16
1/8	1/2	1	STB-416A	3.02
1/8	1/2	1-1/2	STB-416B	4.53
1/8	1/2	3	STB-416C	9.06
1/8	1/2	6	STB-416	18.11
1/8	1/2	12	STB-416L	36.21
1/8	5/8	6	STB-420	22.63
1/8	5/8	12	STB-420L	45.26
1/8	3/4	6	STB-424	27.16
1/8	3/4	12	STB-424L	54.32
1/8	1	6	STB-432	36.21
1/8	1	12	STB-432L	114.10
3/16	3/16	12	STB-66L	17.97
3/16	1/4	3	STB-68A	7.27
3/16	1/4	6	STB-68	13.55
3/16	1/4	12	STB-68L	27.09
3/16	5/16	3	STB-610A	8.48
3/16	5/16	6	STB-610	16.93
3/16	5/16	12	STB-610L	33.87
3/16	3/8	3	STB-612A	10.16
3/16	3/8	6	STB-612	20.32
3/16	3/8	12	STB-612L	40.64
3/16	1/2	3	STB-616A	13.55
3/16	1/2	6	STB-616	27.10
3/16	1/2	12	STB-616L	54.19
3/16	5/8	3	STB-620A	12.84

C2 MEDIUM  
GRAIN CARBIDE  
6-8% COBALT

OTHER GRADES  
AVAILABLE UPON  
REQUEST

MINIMUM GRIND  
STOCK TOLERANCES

THICKNESS +0.008"  
WIDTH +0.012"  
LENGTH +0.008"

PARALLEL AND FLAT  
WITHIN 0.020"

ADDITIONAL  
QUANTITY  
DISCOUNTS  
AVAILABLE

SEE PAGE 15  
FOR  
CARBIDE  
DRILL BLANKS

**WILLIAM T. HUTCHINSON CO.**

TOLL FREE 1-800-544-7934 • 453 LEHIGH AVENUE • UNION, NEW JERSEY 07083-7926

[www.hssblanks.com](http://www.hssblanks.com)

# INDEXABLE INSERTS & DOVETAIL TOOL BLANKS

## Triangular High Speed Steel T15 Inserts

Style Number	ANSI Standard	DIMENSIONS			PRICE PER PIECE
		S	T	R	
30074	TPG-322	.375	.125	.031	11.30
30085	TPG-433	.500	.188	.047	13.74
30096	TPG-544	.625	.250	.062	21.13

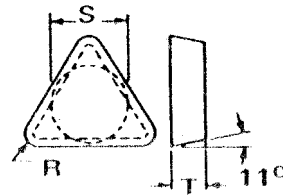

## Square High Speed Steel T15 Inserts

Style Number	ANSI Standard	DIMENSIONS			PRICE PER PIECE
		S	T	R	
30110	SPG-322	.375	.125	.031	10.02
30121	SPG-422	.500	.125	.031	11.84
30132	SPG-633	.750	.188	.047	17.75

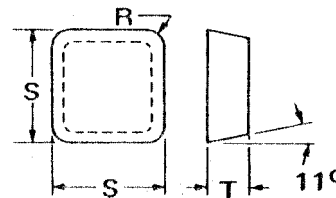

All sizes fit standard positive rake holders same as used for carbide inserts. Other radii available on application. Standard package quantity 10 pieces.

### Dovetail Form Tool Blanks (M42)

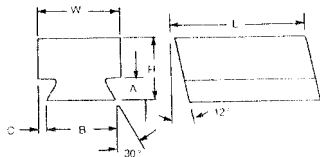

Dovetail Form Tool Holder	H	W	L	A	B	C	Style	Price Per Piece	Style Number
	+0.015 -0.000	+0.015 -0.000	±0.030	+0.015 -0.000	±0.003	±0.005			
3/8	3/4	1	1-1/2	19/64	.700	1/4	3/8-DF-1	41.57	35588
5/8	1	1	2-1/4	19/64	.951	1/16	5/8-DF-1	63.84	35599
5/8	1	1-1/2	2-1/4	19/64	.951	9/16	5/8-DF-2	83.93	35602
5/8	1	2	2-1/4	19/64	.951	17/32	5/8-DF-3	104.39	35613
1	1-1/2	2	3	35/64	1.614	3/16	1-DF-1	176.22	35624
1	1-1/2	2-1/2	3	35/64	1.614	7/16	1-DF-2	211.66	35635
1	1-1/2	3	3	35/64	1.614	11/16	1-DF-3	248.34	35646
1-1/4	1-1/2	2	3	35/64	1.882	1/8	1-1/4-DF-1	180.34	35657
1-1/4	1-1/2	2-1/2	3	35/64	1.882	9/16	1-1/4-DF-2	215.76	35668
1-1/4	1-1/2	3	3	35/64	1.882	9/16	1-1/4-DF-31	250.60	35679
1-5/8	1-1/2	3	3	35/64	2.238	3/8	1-5/8DF-1	255.56	35690
2-1/8	1-1/2	3	3	43/64	2.883	1/8	2-1/8DF-1	259.00	35704

### Dovetail Shave Tool Blanks (M42)

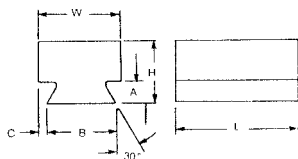

Dovetail Shave Tool Holder	H	W	L	A	B	C	Style	Price Per Piece	Style Number
	+0.015 -0.000	+0.015 -0.000	±0.030	+0.015 -0.000	±0.003	±0.005			
1/2	5/8	1-1/4	1-1/8	13/64	.714	3/8	1/2-DS-1	34.68	35715
5/8	3/4	1	1-1/2	17/64	.912	3/32	5/8-DS-1	40.52	35726
5/8	3/4	1-1/2	1-1/2	17/64	.912	19/64	5/8-DS-2	52.89	35737
5/8	3/4	2	1-1/2	17/64	.912	35/64	5/8-DS-3	64.76	35748
1	1	1-1/2	1-3/4	17/64	1.287	7/32	1-DS-1	67.94	35759
1	1	2	1-3/4	17/64	1.287	23/64	1-DS-2	83.99	35770
1-1/4	1	2	1-3/4	17/64	1.554	11/32	1-1/4-DS-1	88.11	35781
1-1/2	1	2	1-7/8	17/64	1.787	7/32	1-1/2-DS-1	92.81	35792
1-5/8	1-1/2	2-1/2	2-9/16	25/64	2.057	11/32	1-5/8DS-1	180.49	35806

## WILLIAM T. HUTCHINSON CO.

TOLL FREE 1-800-544-7934 • (908) 688-0533 • FAX (908) 688-8296 • ESTABLISHED 1927

# CUTOFF WHEELS & SAFETY FLANGES

DIAMETER	WIDTH	BORE	PRICE
7"	1/32 1/16	1-1/4	\$ 5.80
8"	1/32 1/16	1-1/4	\$ 6.85

Hutchinson tool room cut off wheels are designed by toolmakers for toolmakers. These wheels are formulated for tool room applications where precise cutting is required.



## REINFORCED CUTOFF WHEELS

DIAMETER	WIDTH	BORE	PRICE
10"	1/16	5/8	\$9.90
12"	1/32	1-1/4 1" (w/bushing)	\$11.80

Free cutting, long lasting, designed for applications where the workpiece is hand clamped or side pressure is evident. Center reinforced for reduced drag.

## — TRU-GRIP — TOOLMAKERS SAFETY FLANGES

CONFORMS TO ANSI SAFETY CODE 5-1-1

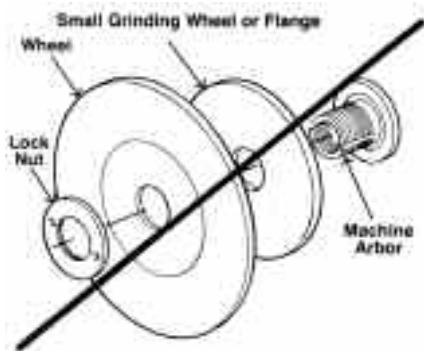

INCORRECT TO ANSI SAFETY CODE 5-1-1

### USES

- Mounting of thin Cut Off Wheels
- Mounting of thin Diamond Wheels
- Mounting of thin Grinding Wheels
- Mounting of thin Borazon Wheels
- Uniform Location
- For use with 6", 7", 8", 10" Diameter Wheels

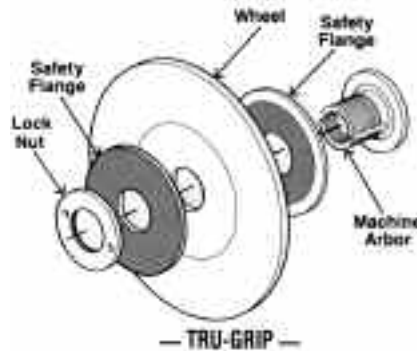

CORRECT TO ANSI SAFETY CODE 5-1-1

### FEATURES

- Protective Balance
- Positive Clamping
- Reduces Wheel Distortion
- Recessed to Safety Code
- Reinforced Composite Material for Strength and Safety
- Standard 1 1/4" Arbor Hole

**Only \$17.50 / pair**

**WILLIAM T. HUTCHINSON CO.**

TOLL FREE 1-800-544-7934 • 453 LEHIGH AVENUE • UNION, NEW JERSEY 07083-7926

[www.hssblanks.com](http://www.hssblanks.com)

# DIAMOND WHEELS AND TOOLS

## TYPE 11V9 FLARING CUP DIAMOND WHEELS

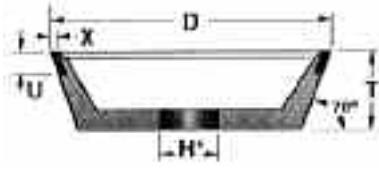

100% CONCENTRATION

D IN.	T IN.	U IN.	X IN.	PRICE EACH
3 3/4	1 1/2	3/8	1/16	99.00
			1/8	115.00
5	1 1/4	7/16	1/16	130.00
			1/8	150.00

AVAILABLE IN GRIT SIZES  
 320-(FINE)  
 150-(MEDIUM)  
 100-(COARSE)  
 Specify (H) hole size

## TYPE 1A1 STRAIGHT STYLE 6" DIAMOND WHEELS

T IN.	X IN.	PRICE EACH
1/8	1/8	114.00
1/4	1/16	128.00
1/4	1/8	138.00
3/8	1/8	169.00
1/2	1/8	190.00

AVAILABLE IN GRIT SIZES  
 320-(FINE)  
 150-(MEDIUM)  
 100-(COARSE)  
 100% CONCENTRATION  
 Specify (H) hole size

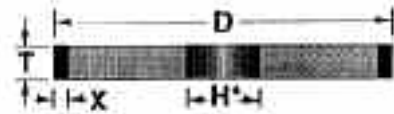

## TYPE 6A2C CUP STYLE DIAMOND WHEELS WITH COUNTERSUNK BOLT HOLES

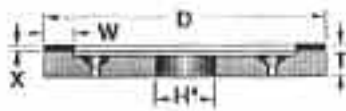

D IN.	T IN.	W IN.	X IN.	PRICE EACH
6	3/4	3/4	1/16	149.00
			1/8	199.00

75% CONCENTRATION  
 AVAILABLE IN GRIT SIZES  
 320-(FINE)  
 150-(MEDIUM)  
 100-(COARSE)  
 Specify (H) hole size

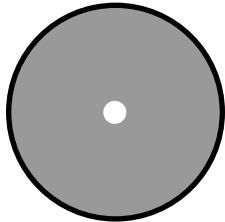

### 6" DIAMOND CUT-OFF WHEEL

.035 Thickness  
 1 1/4" Hole  
 1/4" Diamond Depth  
 100% Concentration  
 GRIT D100  
 80.00 Each

### DIAMOND CLEANING STICK



Aluminum Oxide  
 150 Grit  
 3/4 x 3/4 x 4  
 2.75 Each

## JIG GRINDING MANDRELS

(D) Diameter	(H) Length	(L) Neck	Price Each	(D) Diameter	(H) Length	Price Each
.156	.250	.500	21.75	.390	.375	36.00
.187	.250	.500	22.40	.406	.375	36.65
.203	.250	.500	22.40	.437	.375	39.35
.218	.250	.500	23.10	.500	.375	46.15
.236	.250	.500	23.75	.562	.375	48.20
.250	.250	.500	24.45	.625	.375	50.20
.281	.250	—	25.80	.750	.375	61.75
.312	.375	—	28.50	.875	.375	71.25
.375	.375	—	32.60	1.000	.375	88.90

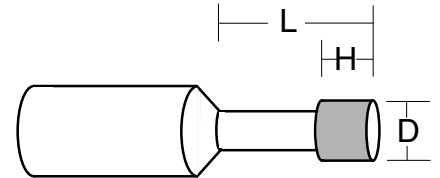

+ .0  
 - .001  
 1/4" Shank  
 100 Grit  
 3" Overall Length

Also Available:  
 1/8" or 3/8" Shank  
 Diameters to .016

# WILLIAM T. HUTCHINSON CO.

TOLL FREE 1-800-544-7934 • (908) 688-0533 • FAX (908) 688-8296 • ESTABLISHED 1927

# DIAMOND TOOLS



## Diamond Plated Needle Nose Files

3" Diamond length  
5½" Overall length  
1/8" shank

Available in grit sizes:

200 FINE  
150 MEDIUM  
100 COARSE

**\$14.90 each**

Tool No.	Style	Cross Section	Size (inches)
NN-1	Oval		.150 x .105
NN-2	Half-round		.218 x .072
NN-3	Equaling		.205 x .508
NN-4	Square		.096 x .096
NN-5	Three Square		.138 x .138
NN-6	Round		.118
NN-7	Crossing		.197 x .088
NN-8	Barretts		.205 x .067

## Diamond Plated Bore Laps

Diameter	Length of Diamond	Price Each
3/16	1/2	32.75
7/32	1/2	34.00
1/4	1/2	37.25
9/32	1/2	39.25
5/16	1/2	42.75
11/32	1/2	46.00
3/8	3/4	49.25
13/32	3/4	53.50
7/16	3/4	56.75
15/32	3/4	66.50
1/2	1	74.25
9/16	1	80.75
5/8	1	91.75
11/16	1	100.50
3/4	1	109.00
7/8	1	117.75
1	1	126.50



STANDARD GRIT 220  
OTHER GRITS AVAILABLE

SCREW ADJUSTMENT EXPANDS  
DIAMETER

CBN PLATED ALSO AVAILABLE

SPECIFY BARREL OR BLIND HOLE  
LAP WHEN ORDERING

NEEDLE EYE LAPS AVAILABLE TO  
.030 DIA - CALL FOR PRICING

### SINGLE END DIAMOND HAND HONE



L IN.	W IN.	T IN.	L1 IN.	X IN.	PRICE EACH
4	1/4	1/4	1¼	1/8	37.50
6	3/8	3/8	1¼	1/8	46.25

### DOUBLE END DIAMOND HAND HONE



L IN.	W IN.	T IN.	L1 IN.	X IN.	PRICE EACH
4	1/4	1/4	1¼	1/8	60.00
6	3/8	3/8	1¼	1/8	73.75

AVAILABLE IN  
GRIT SIZES  
600-(FINE)  
320-(MEDIUM)  
150-(COURSE)

## WILLIAM T. HUTCHINSON CO.

TOLL FREE 1-800-544-7934 • 453 LEHIGH AVENUE • UNION, NEW JERSEY 07083-7926

# DOWEL PINS

PRICE PER 100

Length	Diameter					
	1/16	3/32	1/8	3/16	1/4	5/16
3/16	10.00	8.20	73.92	—	—	—
1/4	10.06	8.40	43.90	99.60	106.90	—
5/16	10.20	8.60	32.80	69.20	89.60	—
3/8	10.40	8.70	6.30	33.30	35.42	88.20
7/16	10.60	8.80	13.30	55.10	86.76	—
1/2	10.80	9.00	6.38	7.00	9.90	16.00
5/8	11.00	9.20	7.00	7.78	10.20	16.90
3/4	11.20	9.30	7.46	8.00	10.90	17.60
7/8	12.00	9.40	8.54	8.90	12.00	18.60
1	13.40	9.60	9.20	9.48	12.80	19.70
1 1/8	—	—	19.48	24.74	28.70	45.30
1 1/4	97.60	112.80	12.80	12.30	15.20	22.80
1 3/8	—	—	23.60	31.32	32.22	50.30
1 1/2	—	117.60	14.30	13.82	16.80	25.40
1 5/8	—	—	93.02	—	84.60	—
1 3/4	—	143.80	23.40	18.70	21.20	30.00
2	—	—	37.20	24.60	25.40	34.20
2 1/4	—	—	108.70	102.50	29.30	42.80
2 1/2	—	—	122.40	110.70	33.40	45.80
2 3/4	—	—	193.30	143.10	104.00	54.40
3	—	—	292.20	162.20	126.94	58.80
3 1/4	—	—	—	—	144.60	176.30
3 1/2	—	—	—	—	186.60	194.40
3 3/4	—	—	—	—	—	342.70
4	—	—	—	—	367.80	383.20

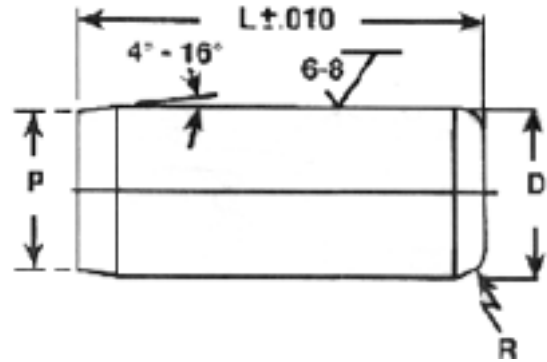

Nom Size	D				P		R	
	STANDARD		.001 Oversized		Point Diameter		Crown height or Radius	
	Max.	Min.	Max.	Min.	Max.	Min.	Max.	Min.
1/16	.0628	.0626	.0636	.0634	0.058	0.048	0.020	0.008
3/32	.0941	.0939	.0949	.0947	0.089	0.079	0.031	0.012
1/8	.1253	.1251	.1261	.1259	0.120	1.110	0.041	0.016
3/16	.1878	.1876	.1886	.1884	0.180	0.179	0.062	0.023
1/4	.2503	.2501	.2511	.2509	0.240	0.230	0.083	0.031
5/16	.3128	.3126	.3136	.3134	0.302	0.290	0.104	0.039
3/8	.3753	.3751	.3761	.3759	0.365	0.350	0.125	0.047
7/16	.4378	.4376	.4386	.4384	0.424	0.409	0.146	0.055
1/2	.5003	.5001	.5011	.5009	0.486	0.471	0.167	0.063
5/8	.6253	.6251	.6261	.6259	0.611	0.595	0.208	0.078
3/4	.7503	.7501	.7511	.7509	0.735	0.715	0.250	0.094
7/8	.8753	.8751	.8761	.8759	0.860	0.840	0.293	0.109
1	1.0003	1.0001	1.0011	1.0009	0.980	0.960	0.333	0.125

PRICE PER 100

Length	Diameter							
	3/8	7/16	1/2	9/16	5/8	3/4	7/8	1"
1/2	20.80	149.20	162.90	—	—	—	—	—
5/8	21.40	—	130.40	—	—	—	—	—
3/4	22.50	82.42	47.70	—	134.00	350.16	—	—
7/8	25.30	110.00	117.68	—	—	—	—	—
1	26.50	48.40	49.60	390.46	90.10	285.30	872.00	976.00
1 1/8	50.60	—	114.00	—	—	—	—	904.00
1 1/4	29.80	52.10	53.10	484.70	100.60	259.30	—	852.00
1 3/8	56.80	—	—	—	—	326.00	—	742.00
1 1/2	35.00	55.80	58.30	579.00	108.20	220.96	690.80	620.00
1 5/8	—	61.70	142.60	—	—	408.00	—	—
1 3/4	44.80	70.30	67.46	644.04	120.70	236.60	594.00	609.00
2	47.80	121.26	77.40	769.70	131.60	202.60	419.50	449.20
2 1/4	52.20	87.00	86.06	819.06	141.50	252.80	575.40	522.20
2 1/2	57.50	158.90	95.56	868.50	154.00	260.70	443.92	537.80
2 3/4	77.60	121.10	163.70	947.00	196.02	299.80	632.88	688.30
3	65.20	312.28	109.50	1090.60	189.90	303.50	565.40	618.60
3 1/4	153.10	359.10	195.80	—	280.80	369.90	742.26	922.70
3 1/2	168.90	410.70	161.30	1283.60	243.00	383.20	656.22	780.80
3 3/4	291.32	—	242.86	—	336.50	—	—	—
4	249.84	475.70	185.80	1595.48	281.10	446.00	746.60	866.20
4 1/2	—	—	685.20	1731.80	322.20	548.00	842.60	957.00
5	—	—	740.54	1888.30	367.90	595.40	929.20	1190.72
5 1/2	—	—	1466.00	—	—	—	—	—
6	—	—	1760.00	—	1164.00	836.30	1036.50	1732.00

- All pins are heat treated to Rockwell 60-64C
- .001 oversized ± .0001  
Prices on application
- Made in USA
- Dowel pins can be custom ground to special diameters to meet your requirements

**NO MINIMUM ORDER  
NO PREMIUM FOR BROKEN  
PACKAGES**

## WILLIAM T. HUTCHINSON CO.

TOLL FREE 1-800-544-7934 • (908) 688-0533 • FAX (908) 688-8296 • ESTABLISHED 1927

# DOWEL PINS

## 303 STAINLESS DOWEL PINS

Length	1/8	3/16	1/4	5/16	3/8	1/2	5/8
1/2	15.18	15.70	16.70	54.00	73.04	—	—
5/8	16.64	17.00	18.28	60.00	76.74	432.98	—
3/4	17.86	19.06	20.00	65.32	79.22	202.66	—
7/8	19.92	20.38	22.60	68.80	85.82	—	—
1	21.18	22.06	26.14	74.00	89.32	183.40	400.92
1 1/4	29.80	37.14	32.44	90.30	96.56	219.00	468.00
1 1/2	34.86	51.02	44.96	96.32	108.50	305.10	544.44
1 3/4	88.60	65.44	70.30	123.20	130.18	352.66	602.16
2	94.94	73.38	78.74	136.88	152.66	464.80	658.32
2 1/2	222.36	222.38	134.08	192.72	200.12	521.20	780.00
3	284.12	320.36	311.10	316.54	266.22	596.88	904.80
3 1/2	372.82	—	472.12	408.80	535.16	688.22	1076.40
4	553.32	—	596.70	605.30	618.84	826.60	1232.40

## METRIC DOWEL PINS

Length in MM	4	5	6	8	10	12	16	20	Length in MM
12	14.28	14.64	16.00	30.66	—	—	—	—	12
14	14.60	15.06	—	—	—	—	—	—	14
16	14.88	15.20	16.90	25.40	68.00	—	—	—	16
18	17.74	18.78	—	—	60.60	—	—	—	18
20	16.84	17.06	18.10	28.40	38.64	70.26	288.00	—	20
25	19.00	19.74	20.20	30.70	41.80	80.14	268.00	384.00	25
30	19.78	20.50	22.10	32.70	44.78	84.82	135.54	262.92	30
35	21.36	22.82	25.70	36.90	45.90	94.30	160.20	—	35
40	28.60	29.26	32.80	38.00	46.20	100.98	177.56	368.00	40
45	—	—	37.00	41.00	58.16	105.48	201.48	—	45
50	31.60	35.68	41.40	44.40	59.62	121.00	224.80	380.70	50
55	62.90	51.26	47.68	53.22	63.50	145.84	—	—	55
60	80.84	67.82	54.90	58.00	69.30	150.86	273.20	449.70	60
65	—	111.00	106.00	70.40	74.10	155.76	—	—	65
70	138.30	117.44	—	88.30	98.42	160.06	318.00	538.90	70
80	—	—	286.00	226.00	214.80	192.94	—	588.00	80
90	—	—	368.80	280.68	273.32	256.28	488.80	—	90
100	—	—	424.24	—	296.20	282.08	—	772.00	100

## METRIC PULL DOWEL PINS

Length in MM	6	8	10	12	16	20	Length in MM
20	118.34	131.50	144.60	329.20	—	—	20
25	127.80	132.58	156.36	174.50	494.00	—	25
30	129.80	134.58	167.40	186.00	532.00	668.00	30
35	132.16	138.30	183.54	192.06	366.00	586.00	35
40	134.70	141.48	196.84	200.66	292.38	351.16	40
45	140.60	157.60	203.30	213.40	299.48	381.50	45
50	147.44	162.30	209.68	218.08	310.24	396.00	50
55	158.38	219.30	237.20	237.80	317.60	564.36	55
60	165.60	193.54	266.40	276.30	320.94	414.14	60
70	214.22	208.00	286.18	295.40	335.36	494.30	70
75	—	—	336.40	318.96	368.00	626.00	75
80	275.20	243.66	366.00	424.00	540.44	561.48	80
100	—	—	502.22	575.66	902.00	942.24	100

**ALL PRICES  
PER 100**

**NO PREMIUM  
FOR BROKEN  
PACKAGES**

**NO MINIMUM  
ORDER**

## WILLIAM T. HUTCHINSON CO.

TOLL FREE 1-800-544-7934 • 453 LEHIGH AVENUE • UNION, NEW JERSEY 07083-7926

# SOCKET HEAD CAP & SET SCREWS

## BUTTON HEAD SOCKET CAP SCREWS

Length	4/40	6/32	8/32	10/24	10/32	1/4-20	5/16-18	3/8-16
1/4	4.24	4.60	4.70	4.90	4.90	—	—	—
3/8	4.34	4.70	4.80	5.20	5.40	6.90	—	—
1/2	4.34	4.90	5.80	5.90	6.30	7.20	9.20	13.30
5/8	—	5.30	6.00	6.10	6.90	7.40	9.90	14.00
3/4	—	—	6.30	6.60	7.10	8.10	11.50	14.80
1	—	—	—	8.00	8.20	8.70	13.00	17.20
1 1/4	—	—	—	—	—	—	—	18.90

## METRIC SOCKET HEAD CAP SCREWS

Length	M8	M10
16	10.30	—
20	10.90	17.90
25	11.90	19.00
30	13.10	20.20
35	14.00	21.40
40	15.30	23.50
45	16.90	25.80
50	19.20	28.20
55	23.60	30.30
60	26.80	32.50
65	32.80	34.20
70	33.10	37.90
75	42.80	49.90

**All Prices are Per 100  
No Premium for Broken Packages**

## FLAT HEAD SOCKET CAP SCREWS

Length	4/40	5/40	6/32	8/32	10/24	10/32	1/4-20	5/16-18	3/8-16	1/2-13	5/8-11	3/4-10
1/4	3.60	4.60	5.30	—	—	—	—	—	—	—	—	—
3/8	4.00	4.80	5.40	5.80	6.40	6.40	7.70	—	—	—	—	—
1/2	4.20	4.90	5.50	6.20	6.70	6.70	7.40	10.38	—	—	—	—
5/8	4.60	5.40	5.80	6.60	7.00	7.00	8.10	10.82	—	—	—	—
3/4	5.00	5.70	6.20	6.90	7.20	7.20	8.80	11.34	14.00	27.88	—	—
1	—	—	—	6.80	8.00	8.00	9.60	12.30	16.96	30.42	—	—
1 1/4	—	—	—	—	9.40	9.40	10.30	13.36	19.08	33.70	60.00	—
1 1/2	—	—	—	—	10.70	10.70	11.20	15.16	20.24	36.26	68.00	108.00
1 3/4	—	—	—	—	—	—	12.20	17.80	22.48	41.56	74.00	118.00
2	—	—	—	—	—	—	14.60	19.08	25.44	45.36	82.80	131.60
2 1/4	—	—	—	—	—	—	—	—	—	48.54	90.00	152.60
2 1/2	—	—	—	—	—	—	—	—	—	53.42	98.80	164.00
3	—	—	—	—	—	—	—	—	—	62.76	112.60	186.60

## SOCKET SET SCREWS – CUP POINT (OTHER POINTS AND DIAMETERS AVAILABLE PRICES ON APPLICATION)

Length	0/80	1/72	2/56	3/48	4/40	5/40	6/32	8/32	10/24	10/32
1/16	—	11.84	7.24	—	—	—	—	—	—	—
3/32	12.32	11.96	7.36	7.24	—	—	—	—	—	—
1/8	12.56	12.32	7.48	7.36	3.80	4.40	3.70	4.30	—	—
3/16	13.04	12.92	7.60	7.48	3.90	4.50	3.80	3.90	3.90	3.90
1/4	13.78	13.78	7.70	7.60	4.80	5.00	3.90	4.00	4.00	4.00
5/16	—	—	—	—	4.90	5.20	4.60	5.20	5.50	5.50
3/8	—	—	—	—	5.10	5.60	5.00	4.80	4.80	4.80
1/2	—	—	—	—	6.00	6.20	5.30	5.20	5.20	5.20
5/8	—	—	—	—	—	—	—	—	7.40	7.40
3/4	—	—	—	—	—	—	—	—	7.70	7.10
1	—	—	—	—	—	—	—	—	—	9.50
1 1/4	—	—	—	—	—	—	—	—	—	13.20

Length	1/4-20	1/4-28	5/16-18	5/16-24	3/8-16	3/8-24	1/2-13
3/16	5.00	5.40	—	—	—	—	—
1/4	4.20	4.30	7.20	9.70	10.80	12.60	—
5/16	4.40	5.20	5.60	8.90	11.10	13.40	—
3/8	4.80	5.10	6.00	9.20	7.00	13.80	—
1/2	5.50	6.00	7.80	10.50	7.80	14.30	17.60
5/8	7.20	—	9.50	11.90	12.60	14.80	18.00
3/4	8.10	—	11.00	13.00	11.90	15.40	23.80
1	10.80	—	14.80	18.40	16.80	19.80	30.40
1 1/4	16.40	—	20.60	—	27.00	30.60	36.60
1 1/2	22.60	—	27.20	—	33.60	37.20	46.90

## WILLIAM T. HUTCHINSON CO.

TOLL FREE 1-800-544-7934 • (908) 688-0533 • FAX (908) 688-8296 • ESTABLISHED 1927

# SOCKET HEAD CAP SCREWS

Length	0/80	1/72	2/56	3/48	4/40	5/40	6/32	6/40	8/32	8/36	10/24	10/32	1/4-20	1/4-28
1/8	7.20	7.20	—	—	—	—	—	—	—	—	—	—	—	—
3/16	7.20	7.20	7.20	7.20	—	—	—	—	—	—	—	—	—	—
1/4	7.44	7.92	7.30	7.30	3.50	3.60	3.00	—	3.40	—	—	—	—	—
3/8	8.04	8.16	7.50	7.50	3.60	3.70	3.10	4.04	3.52	4.14	3.90	4.08	5.32	6.68
1/2	—	—	8.00	8.00	3.70	3.90	3.20	4.14	3.66	4.24	3.94	3.90	4.90	5.80
5/8	—	—	—	—	4.00	4.30	3.60	4.24	3.96	—	4.02	4.20	4.28	6.00
3/4	—	—	—	—	4.20	4.60	3.70	4.54	4.08	4.54	4.12	4.32	4.58	6.20
7/8	—	—	—	—	—	—	4.00	—	4.40	—	4.54	4.50	4.90	—
1	—	—	—	—	—	—	4.20	—	4.62	—	4.70	4.84	5.24	7.00
1 1/4	—	—	—	—	—	—	—	—	5.56	—	5.74	6.00	5.58	7.60
1 1/2	—	—	—	—	—	—	—	—	6.00	—	6.28	6.60	6.26	8.60
1 3/4	—	—	—	—	—	—	—	—	—	—	6.88	7.20	7.22	10.30
2	—	—	—	—	—	—	—	—	—	—	7.50	7.74	7.86	11.30
2 1/4	—	—	—	—	—	—	—	—	—	—	—	—	12.20	—
2 1/2	—	—	—	—	—	—	—	—	—	—	—	—	13.20	—
2 3/4	—	—	—	—	—	—	—	—	—	—	—	—	15.26	—
3	—	—	—	—	—	—	—	—	—	—	—	—	16.94	—

## PRICES PER 100

Length	5/16-18	5/16-24	3/8-16	3/8-24	7/16-14	1/2-13	1/2-20	5/8-11	3/4-10	1-8
1/2	8.30	—	16.30	—	—	47.60	—	—	—	—
5/8	7.60	9.60	10.60	—	—	—	—	—	—	—
3/4	7.40	10.00	10.52	14.10	24.60	30.30	—	—	—	—
7/8	7.74	10.70	10.80	—	24.00	30.70	—	—	—	—
1	8.24	11.20	11.40	16.00	27.70	31.20	36.40	61.80	—	—
1 1/4	8.94	12.20	12.60	17.00	29.00	33.48	39.00	63.00	108.80	—
1 1/2	9.64	13.20	14.52	19.00	30.40	36.34	45.50	66.00	111.50	—
1 3/4	11.14	14.40	15.94	21.00	33.70	39.20	49.40	73.20	113.60	—
2	12.14	15.60	17.50	24.40	37.30	42.00	52.00	80.80	120.90	272.70
2 1/4	15.76	—	20.00	—	42.90	45.40	57.20	86.40	128.20	291.10
2 1/2	16.24	—	22.40	—	46.80	49.70	65.00	91.80	138.70	310.90
2 3/4	21.20	—	28.20	—	58.10	53.30	—	93.40	145.40	332.40
3	23.60	—	31.40	—	68.20	57.40	72.80	102.40	155.60	353.90
3 1/4	28.84	—	42.80	—	—	70.00	—	106.60	165.20	375.30
3 1/2	33.52	—	45.00	—	—	73.60	—	120.70	174.10	396.80
4	—	—	52.20	—	—	88.30	—	137.00	197.50	439.80
4 1/2	—	—	60.00	—	—	103.40	—	153.70	218.20	482.70
5	—	—	70.00	—	—	128.20	—	170.80	241.60	525.70
5 1/2	—	—	—	—	—	132.80	—	174.14	264.40	568.60
6	—	—	—	—	—	151.80	—	197.42	283.50	611.60
6 1/2	—	—	—	—	—	188.96	—	272.82	364.20	690.00
7	—	—	—	—	—	228.00	—	282.78	395.40	720.00
8	—	—	—	—	—	272.00	—	340.40	558.00	850.00

**NO PREMIUM FOR BROKEN PACKAGES**

**Also Available:**

**COMPLETE LINE OF  
HOLO-KROME FASTENERS**

**CALL 1-800-544-7934 TO REQUEST  
LATEST HOLO-KROME CATALOG**



**WILLIAM T. HUTCHINSON CO.**

TOLL FREE 1-800-544-7934 • 453 LEHIGH AVENUE • UNION, NEW JERSEY 07083-7926

[www.hssblanks.com](http://www.hssblanks.com)

## LIXIE HAMMERS AND MALLETS

**SOFT FACE DEAD BLOW****Hammers, Mallets and Sledges with Replaceable Faces**

All Lixie Dead Blow striking tool head castings feature an unobstructed cavity, partially filled with iron shot. As the hammer is struck on a surface, the urethane face absorbs a portion of the blow's energy. The shot moves forward immediately behind the blow, dampening the rebound and insuring that the force of the blow is transmitted solidly to the struck surface. Lixie Dead Blow Hand Hammers and Mallets are available in 6 sizes, with a selection of two weights in each size. The rugged head casting is of either malleable iron (Heavy Dead Blow) or hi-tensile, non-sparking Aluminum (Light Dead Blow).

Lixie Dead Blow Sledges have the same features as the Hammers and Mallets. They are used where a heavy blow is desired, yet still retain the highly protective quality of Lixie urethane. They are available in 3 sizes with 2 weights in each size furnished with smooth hickory grip handles.

SEE PAGE 55 FOR AVAILABLE FACES

LIXIE  
Dead  
Blow  
SledgeLIXIE  
Dead  
Blow  
Mallet

	MODEL	HEAD DIAM.	HEAD LENGTH	OVERALL LENGTH	WEIGHT (OUNCES)	PRICE EACH
<b>HAMMERS &amp; MALLETS</b>	*100L-MH	1"	4-1/4"	11"	10	28.00
	100H-MH	1"	4-1/4"	11"	14	27.90
	*125L-MH	1-1/4"	4-7/8"	12"	14	31.40
	125H-MH	1-1/4"	4-7/8"	12"	22	31.10
	*150L-MH	1-1/2"	5-1/4"	13"	22	37.90
	150H-MH	1-1/2"	5-1/4"	13"	30	37.00
	*200L-MH	2"	6-1/4"	15"	38	52.60
	200H-MH	2"	6-1/4"	15"	56	48.90
	*250L-MH	2-1/2"	7"	17"	66	90.90
	250H-MH	2-1/2"	7"	17"	100	81.90
<b>SLEDGES</b>	*300L-MH	3"	8-1/2"	19"	116	117.40
	300H-MH	3"	8-1/2"	19"	168	121.70
	*250L-MH-32	2-1/2"	7-1/8"	32"	80	127.70
	250H-MH-32	2-1/2"	7-1/8"	32"	114	131.90
	*300L-MH-35	3"	8-1/2"	35"	120	156.10
300H-MH-35	3"	8-1/2"	35"	180	183.10	

**HAMMERS FURNISHED COMPLETE WITH 2 FACES**

Grade of face may be interchanged without increase in cost. Where not specified standard face makeup of Medium and Hard (MH) will be furnished.

\*All L-Light Dead Blow models are sparkproof.

**WILLIAM T. HUTCHINSON CO.**

TOLL FREE 1-800-544-7934 • (908) 688-0533 • FAX (908) 688-8296 • ESTABLISHED 1927

# LIXIE HAMMERS AND MALLETS

## MULTI HAMMER

### with Replaceable Urethane Face

ONE HAMMER DOES THE JOB OF TWO! With a flip of the wrist you can switch from a sparkproof bronze to a soft, protective urethane face without fumbling for another hammer. Lixie's exclusive all-purpose model has a machinist's head cast in our special bronze alloy, with the opposite face incorporating replaceable screw-in faces in your choice of 4 grades, soft to hard. The handle is Grade A hickory with an exclusive non-slip grooved handle and special epoxy wedge construction. The All-Purpose hammer comes in a choice of 3 sizes with face diameters of 1", 1-1/4" or 1-1/2".



MODEL	HEAD DIAM.	HEAD LENGTH	OVERALL LENGTH	WEIGHT (OUNCES)	PRICE EACH
AB 100-T	1"	3-7/8"	12-1/2"	16	32.20
AB 125-T	1-1/4"	4-3/8"	13"	26	39.70
AB 150-T	1-1/2"	5"	13"	36	53.60

#### HAMMERS FURNISHED COMPLETE WITH 1 URETHANE FACE

Grade of face may be interchanged without increase in cost. Where not specified standard Tough grade (T) will be furnished. All are sparkproof.

## REPLACEABLE URETHANE SCREW-IN FACES

Lixie screw-type replaceable polyurethane faces are included on all Lixie Dead Blow and Multi Hammers. They are available in six sizes, with a range of four hardnesses in each size. This permits custom fitting a Lixie hammer to your individual requirements. Impervious to oils and most solvents, these solid polyurethane faces have high impact absorption, yet will not mar,peen or deform the struck surface.



#### COLOR DENOTES HARDNESS

COLOR	DIAMETER					
	1"	1-1/4"	1-1/2"	2"	2-1/2"	3"
BROWN (Soft)	5.82	6.48	8.01	10.90	19.70	27.45
GREEN (Medium)	5.82	6.48	8.01	10.90	19.70	27.45
RED (Tough)	5.82	6.48	8.01	10.90	19.70	27.45
BLACK (Hard)	7.74	8.63	10.70	15.80	28.60	40.60

NOTE: Order face diameter to coincide with hammer diameter. Faces packaged one each per container.

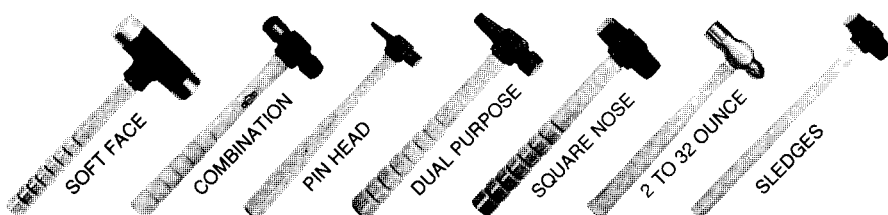

To request full line brochure of Lixie Hammers - Call 1-800-544-7934

### WILLIAM T. HUTCHINSON CO.

TOLL FREE 1-800-544-7934 • 453 LEHIGH AVENUE • UNION, NEW JERSEY 07083-7926

## STEEL SHIM STOCK

Steel Shim Stock is low carbon mild steel cold rolled to a #1 hard temper. It is stiff and springy. The material can be punched or sheared with minimum burring and distortion.

### 1008/1010 Full Hard, AISI1010, QQS 698

#### 6" x 100" Rolls

THICKNESS	PRICE EACH
.001	\$ 9.07
.0015	10.77
.002	6.21
.0025	6.53
.003	7.86
.004	7.58
.005	6.93
.006	6.62
.007	6.91
.008	6.85
.009	7.18
.010	7.30
.012	7.16
.015	7.43
.018	8.45
.020	8.72
.025	9.33
.031	9.81

#### 6" x 180" Rolls

THICKNESS	PRICE EACH
.001	\$ 18.76
.0015	22.30
.002	12.84
.0025	13.51
.003	16.38
.004	15.69
.005	14.32
.006	13.71
.007	14.29
.008	14.19
.009	14.85
.010	15.12
.012	14.81
.015	15.38
.018	17.51
.020	18.08
.025	19.30
.031	20.33

#### Assortments

12 Pak – 1 Pc. each 6"x12"		
\$ 27.25		
.001	.0015	.002
.003	.004	.005
.006	.007	.008
.010	.012	.015
15 Pak – 1 Pc. each 6"x12"		
\$ 31.74		
.001	.0015	.002
.003	.004	.005
.006	.007	.008
.010	.012	.015
.020	.025	.031
4 Pak – 1 Pc. each 6"x50"		
\$ 28.83		
.001		
.002		
.003		
.005		

## BRASS SHIM STOCK

Use Brass Shim Stock where some stiffness is required and where corrosion problems exist. 70% copper and 30% zinc it has been cold rolled to a 1/2 hard temper, Rockwell hardness of 30T 56/68.

### 260 Half Hard

#### 6" x 100" Rolls

THICKNESS	PRICE EACH
.001	\$ 17.93
.0015	18.01
.002	18.58
.003	19.18
.004	20.21
.005	20.91
.006	21.52
.007	22.58
.008	23.82
.009	25.59
.010	27.85
.012	30.15
.015	34.83
.020	40.83
.025	48.77
.031	57.70

#### 6" x 180" Rolls

THICKNESS	PRICE EACH
.001	\$ 32.99
.0015	32.99
.002	32.99
.003	32.99
.004	34.63
.005	39.85
.006	43.37
.007	48.39
.008	48.39
.009	51.54
.010	51.54
.012	64.11
.015	70.88
.020	85.49
.025	102.45
.031	113.14

#### Assortments

12 Pak – 1 Pc. each 6"x12"		
\$ 36.14		
.001	.0015	.002
.003	.004	.005
.006	.007	.008
.010	.012	.015
15 Pak – 1 Pc. each 6"x12"		
\$ 49.28		
.001	.0015	.002
.003	.004	.005
.006	.007	.008
.010	.012	.015
.020	.025	.031
4 Pak – 1 Pc. each 6"x50"		
\$ 40.24		
.001		
.002		
.003		
.005		

## WILLIAM T. HUTCHINSON CO.

TOLL FREE 1-800-544-7934 • (908) 688-0533 • FAX (908) 688-8296 • ESTABLISHED 1927

# STAINLESS STEEL SHIM STOCK

Stainless Steel Shim Stock can be used in any applications where corrosion is a concern, Available as follows:

- 300 Series Full Hard, R/C 40-45
- 302 Half Hard, R/C 30-35
- 302 Annealed
- Stainless Steel Metric

## 300 Series Full Hard, R/C 40-45

### 6" x 50" Rolls

THICKNESS	PRICE EACH
.0005	\$ 52.27
.001	25.21
.0015	23.10
.002	15.96
.003	15.34
.004	14.97
.005	17.22
.006	17.19
.007	17.73
.008	18.01
.009	20.28
.010	18.70
.012	19.53
.015	21.13
.020	25.10
.025	29.39
.031	33.50

### 6" x 60" Rolls

THICKNESS	PRICE EACH
.001	\$ 36.31
.002	22.99
.003	22.08
.004	21.53
.005	24.78
.006	24.75
.007	25.52
.008	25.93
.009	29.20
.010	26.90
.012	28.12
.015	30.41
.020	35.06
.025	41.98
.031	48.24

### 12' x 50" Rolls

THICKNESS	PRICE EACH
.001	\$ 49.98
.002	31.67
.003	31.47
.004	32.10
.005	34.88
.006	39.58
.007	40.27
.008	41.62
.010	42.50
.012	44.38
.015	44.47
.020	48.39
.025	58.19
.031	76.56

## 1/2 Hard Stainless Shim R/C 30-35 AISI 302

### 12" x 50" Rolls

THICKNESS	PRICE EACH
.003	\$ 66.44
.004	71.34
.005	72.11
.006	88.02
.008	92.52
.010	101.72
.012	98.71
.015	93.94
.020	102.22
.025	129.42

## Annealed Stainless Shim AISI 302

### 12" x 50" Rolls

THICKNESS	PRICE EACH
.003	\$ 66.45
.004	71.34
.005	72.11
.006	88.01
.008	92.52
.010	101.72
.012	98.71
.015	93.94
.020	102.22
.025	129.42

## Metric Stainless

300 Series Full Hard, R/C 40-45

### 150mm x 1.25m

THICKNESS	PRICE EACH
.05 mm	\$ 16.81
.10	17.10
.15	18.03
.20	18.91
.25	19.61
.30	20.48
.40	22.19
.50	26.34
.65	30.84
.80	35.15

# WILLIAM T. HUTCHINSON CO.

TOLL FREE 1-800-544-7934 • 453 LEHIGH AVENUE • UNION, NEW JERSEY 07083-7926

# AISI TYPE 0-1 OIL HARDENING GROUND FLAT STOCK

**Overall Length: 18"**

Thickness	Width	Price Each	Thickness	Width	Price Each	Thickness	Width	Price Each	Thickness	Width	Price Each
1/64	1/2	74.57	1/16	5	46.36	1/8	5/8	11.73	3/16	3/8	12.35
	3/4	77.58		6	54.91		3/4	12.62		1/2	14.22
	1	142.61		8	80.54		1	15.00		5/8	15.53
	1-1/4	85.40		10	99.69		1-1/4	17.23		3/4	16.70
	1-1/2	90.54	5/64	1/4	33.31		1-1/2	19.67		1	19.66
	2	116.75		5/16	28.65		1-3/4	22.15		1-1/4	22.49
	2-1/2	133.90		3/8	18.28		2	24.49		1-1/2	25.48
	3	160.36		1/2	10.05		2-1/2	29.29		1-3/4	28.49
4	215.97	3/4		12.63	3		34.09	2		31.49	
		1		15.24	3-1/2		38.93	2-1/2		37.45	
1/32	1/2	12.68	1-1/4	18.92	4		43.70	3		43.51	
	3/4	16.77	1-1/2	20.45	4-1/2		48.52	3-1/2		49.51	
	1	20.17	2	25.69	5		53.31	4	55.43		
	1-1/4	24.01	2-1/2	30.87	6		62.82	5	67.43		
	1-1/2	27.67	3	36.11	7	81.35	6	79.40			
	2	35.04	4	46.59	8	92.28	8	115.79			
	2-1/2	42.48	6	67.51	10	113.88	10	142.65			
	3	50.10	3/32	1/4	33.31	12	135.59	12	169.73		
3-1/2	57.57	5/16		28.65	9/64	9/64	20.90	7/32	7/32	18.77	
4	65.10	3/8		18.28		1/2	11.82		5/16	29.92	
6	114.90	1/2		10.48		3/4	13.85		3/8	23.57	
3/64	1/4	50.48		3/4		13.05	1		17.34	1/2	16.49
	5/16	44.13		1		15.72	1-1/4		20.04	3/4	20.06
	3/8	27.99	1-1/4	18.29		1-1/2	22.76		1	23.66	
	1/2	11.26	1-1/2	20.90		2	28.30		1-1/4	27.03	
	3/4	14.56	1-3/4	23.54		3	39.29		1-1/2	30.61	
	1	17.84	2	26.13		4	50.31		2	37.78	
	1-1/4	20.95	2-1/2	31.42		5/32	5/32		20.19	2-1/2	46.57
	1-1/2	24.19	3	36.68			1/4		30.12	3	52.19
2	30.77	4	47.13	5/16			26.70		4	66.49	
2-1/2	37.08	5	57.62	3/8			17.52	6	95.08		
3	43.61	6	68.09	1/2			12.57	8	126.77		
3-1/2	50.04	8	99.81	3/4	15.51		1/4	1/4	17.60		
4	68.36	10	230.17	1	18.49	5/16		26.58			
6	82.15	7/64	1/2	12.49	1-1/4	21.82		3/8	13.94		
1/16	1/4		26.37	3/4	15.62	1-1/2		24.16	1/2	15.30	
	5/16		29.89	1	18.19	1-3/4		27.05	5/8	16.98	
	3/8		13.33	1-1/4	21.65	2		30.05	3/4	18.49	
	1/2		7.98	1-1/2	24.83	2-1/2		35.89	1	21.78	
	5/8		9.20	2	30.99	3		41.71	1-1/4	24.73	
	3/4	10.16	2-1/2	37.18	3-1/2	47.61		1-1/2	28.07		
	1	12.23	3	43.39	4	53.43		1-3/4	30.98		
	1-1/4	14.41	4	55.77	5	65.17		2	34.39		
1-1/2	16.55	6	83.67	6	76.89	2-1/2		40.83			
1-3/4	18.67	1/8	1/8	21.69	8	112.36	3	45.92			
2	20.79		1/4	7.89	3/16	3/16	19.48	3-1/2	53.69		
2-1/2	25.05		5/16	8.54		1/4	10.82	4	60.10		
3	29.31		3/8	9.17		5/16	11.60	4-1/2	66.54		
3-1/2	33.64		1/2	10.16				5	72.96		
4	37.84										

**Tolerance:** Thickness ± .001  
 Width + .005  
 - .0

**Also Available:**  
 36" Lengths • Oversize • Low Carbon • A-2, D-2, S-7

## WILLIAM T. HUTCHINSON CO.

TOLL FREE 1-800-544-7934 • (908) 688-0533 • FAX (908) 688-8296 • ESTABLISHED 1927

# AISI TYPE 0-1 OIL HARDENING GROUND FLAT STOCK

**Overall Length: 18"**

Thickness	Width	Price Each	Thickness	Width	Price Each	Thickness	Width	Price Each	Thickness	Width	Price Each	
1/4	5-1/2	79.44	3/8	2-1/2	58.86	5/8	5/8	37.16	1	3-1/2	161.34	
	6	85.85		3	68.06		3/4	40.47		4	180.35	
	7	110.69		3-1/2	77.29		1	47.09		4-1/2	198.35	
	8	125.34		4	86.47		1-1/4	53.56		5	217.58	
	10	154.29		4-1/2	95.66		1-1/2	60.17		6	254.45	
	12	183.36		5	104.85		2	73.41		8	324.41	
	14	211.66		5-1/2	114.10		2-1/2	86.66		10	443.02	
9/32	9/32	18.36	7/16	7/16	31.14	3/4	3-1/2	113.22	1-1/8	1-1/8	86.65	
	1/2	17.66		1/2	26.71		4	126.48		1-1/2	102.26	
	3/4	21.34		3/4	32.09		5	153.70		2	123.10	
	1	25.01		1	37.76		6	180.22		3	164.78	
	1-1/4	28.41		1-1/4	42.45		7	219.71		4	206.47	
	1-1/2	32.14		1-1/2	47.85		8	259.22		6	289.68	
	1-3/4	35.79		2	58.63		10	312.64	1-1/4	1-1/4	96.75	
	2	39.45	2-1/2	69.30	12	372.79	1-1/2	108.05				
	2-1/2	46.73	3	80.10	1/2	1/2	27.55	2		130.69		
	3	54.09	4	99.34		5/8	30.37	2-1/2		153.27		
	4	68.69	6	144.64		3/4	33.14	3		175.89		
6	97.95	1	38.75	1		38.75	4	221.10				
5/16	5/16	19.15	1-1/4	44.18		1-1/4	44.18	5	267.14			
	3/8	16.75	1-1/2	49.74		1-1/2	49.74	6	312.36			
	1/2	18.35	1-3/4	55.51		1-3/4	55.51	8	440.60			
	5/8	20.27	2	60.94		2	60.94	10	498.88			
	3/4	22.19	2-1/2	71.75		2-1/2	71.75	1-1/2	1-1/2	126.42		
	1	26.03	3	83.65		3	83.65		2	152.59		
	1-1/4	29.55	3-1/2	94.55		3-1/2	94.55		2-1/2	178.71		
	1-1/2	33.35	4	105.74	4	105.74	3		204.89			
	1-3/4	37.19	4-1/2	116.97	4-1/2	116.97	3-1/2		231.06			
	2	41.00	5	128.88	5	128.88	4		257.20			
	2-1/2	48.64	6	151.25	6	151.25	5	310.28				
	3	56.24	7	196.31	7	196.31	6	362.63				
3-1/2	63.86	8	222.01	8	222.01	8	511.05					
4	71.51	10	267.02	10	267.02	10	621.02					
4-1/2	79.11	12	314.52	12	314.52	2	2	196.42				
5	86.72	14	360.39	14	360.39		3	262.91				
6	101.95	9/16	9/16	33.35	1		1	69.21	4	329.41		
7	131.14		3/4	37.89			1-1/4	78.02	6	428.37		
8	148.70		1	44.19		1-1/2	87.24	2-1/2	2-1/2	335.26		
10	182.56		1-1/4	50.30		1-3/4	96.50		3	482.74		
12	193.70		1-1/2	56.55		2	105.76		4	858.21		
3/8	3/8		24.22	1-1/2		56.55	2-1/2	124.32	3	3	482.74	
	1/2		22.37	2		69.12	3	142.81		4	4	858.21
	5/8		24.66	9/16		9/16	33.35	1			1	69.21
	3/4		26.98			3/4	37.89		1-1/4		78.02	
	1		31.57			1	44.19		1-1/2		87.24	
	1-1/4		35.84			1-1/4	50.30		1-3/4		96.50	
	1-1/2	40.48	1-1/2		56.55	2	105.76					
	1-3/4	46.36	2		69.12	2-1/2	124.32					
2	49.70				3	142.81						

**Tolerance:** Thickness ± .001  
 Width + .005  
 - .0

**Also Available:**

36" Lengths • Oversize • Low Carbon • A-2, D-2, S-7

## WILLIAM T. HUTCHINSON CO.

TOLL FREE 1-800-544-7934 • 453 LEHIGH AVENUE • UNION, NEW JERSEY 07083-7926

# SOLID CARBIDE PLAIN PRESS FIT BUSHINGS

Std. Drill Size A	Actual O.D. B	Length C	Symbol for O.D. Finish Ground
.0135 to .0625	.1578 .1575	1/4	PC-10-4
		5/16	PC-10-5
		3/8	PC-10-6
		1/2	PC-10-8
.0625 to .0995	.2046 .2043	1/4	PC-13-4
		5/16	PC-13-5
		3/8	PC-13-6
		1/2	PC-13-8
.0980 to .1406	.2516 .2513	1/4	PC-16-4
		5/16	PC-16-5
		3/8	PC-16-6
		1/2	PC-16-8
.1250 to .1935	.3141 .3138	3/4	PC-16-12
		1	PC-16-16
		1 1/4	PC-20-4
		1 1/2	PC-20-5
.1875 to .2570	.4078 .4075	1 3/4	PC-20-6
		2	PC-20-8
		2 1/4	PC-20-12
		2 1/2	PC-20-16
.1875 to .3160	.5017 .5014	3	PC-26-4
		3 1/2	PC-26-5
		4	PC-26-6
		4 1/2	PC-26-8
.3125 to .4375	.6267 .6264	5	PC-26-12
		5 1/2	PC-26-16
		6	PC-26-22
		6 1/2	PC-26-28
.3750 to .5312	.7518 .7515	7	PC-32-6
		7 1/2	PC-32-8
		8	PC-32-12
		8 1/2	PC-32-16
.5000 to .6250	.8768 .8765	9	PC-32-22
		9 1/2	PC-32-28
		10	PC-32-34
		10 1/2	PC-40-6
.6250 to .7500	1.0018 1.0015	11	PC-40-8
		11 1/2	PC-40-12
		12	PC-40-16
		12 1/2	PC-40-22
.7500 to 1.0000	1.3772 1.3768	13	PC-40-28
		14	PC-40-34
		14 1/2	PC-40-40
		15	PC-48-8
		15 1/2	PC-48-12
		16	PC-48-16
		16 1/2	PC-48-22
		17	PC-48-28
		17 1/2	PC-48-34
		18	PC-48-40
		18 1/2	PC-56-8
		19	PC-56-12
		19 1/2	PC-56-16
		20	PC-56-22
		20 1/2	PC-56-28
		21	PC-56-34
		21 1/2	PC-64-8
		22	PC-64-12
		22 1/2	PC-64-16
		23	PC-64-22
		23 1/2	PC-64-28
		24	PC-64-34
		24 1/2	PC-64-40
		25	PC-88-12
		25 1/2	PC-88-16
		26	PC-88-22
		26 1/2	PC-88-28
		27	PC-88-34
		27 1/2	PC-88-40
		28	
		28 1/2	
		29	

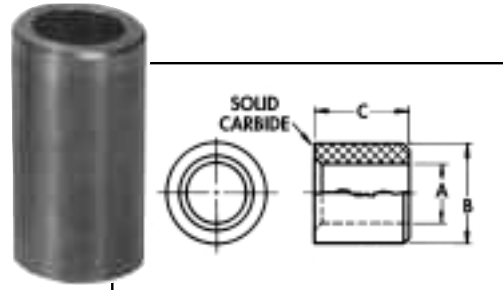

## SOLID CARBIDE SLIP & FIXED RENEWABLE BUSHINGS

ALSO AVAILABLE  
PRICES UPON REQUEST

### STANDARD I.D. TOLERANCES

Up to 1/4	Nominal +.0001/+.0004
Over 1/4 to 3/4	Nominal +.0001/+.0005
Over 3/4 to 1-1/2	Nominal +.0002/+.0006
Over 1-1/2 to 1-3/4	Nominal +.0003/+.0007

### Counterbore

Unless otherwise specified, all Carbide Bushings are supplied without counterbore. (Carbide Bushings with counterbore are priced as specials.)

AVAILABLE IN DRILL SIZES  
UP TO 1.750  
PRICES ON REQUEST

**WILLIAM T. HUTCHINSON CO.**

TOLL FREE 1-800-544-7934 • (908) 688-0533 • FAX (908) 688-8296 • ESTABLISHED 1927

# CARBIDE HEAD PRESS FIT BUSHINGS

Std. Drill Size A	Actual O.D. B	Length C	Symbol for O.D. Finish Ground	HEAD DIMENSIONS	
				F	G
.0135 to .0625	.1578 .1575	1/4 5/16 3/8 1/2	HC-10-4 HC-10-5 HC-10-6 HC-10-8	1/4	3/32
.0625 to .0995	.2046 .2043	1/4 5/16 3/8 1/2	HC-13-4 HC-13-5 HC-13-6 HC-13-8	19/64	3/32
.0980 to .1406	.2516 .2513	1/4 5/16 3/8 1/2 3/4	HC-16-4 HC-16-5 HC-16-6 HC-16-8 HC-16-12	23/64	3/32
.1250 to .1935	.3141 .3138	1/4 5/16 3/8 1/2 3/4 1	HC-20-4 HC-20-5 HC-20-6 HC-20-8 HC-20-12 HC-20-16	27/64	1/8
.1875 to .2570	.4078 .4075	1/4 5/16 3/8 1/2 3/4 1 1-3/8	HC-26-4 HC-26-5 HC-26-6 HC-26-8 HC-26-12 HC-26-16 HC-26-22	1/2	5/32
.1875 to .3160	.5017 .5014	3/8 1/2 3/4 1 1-3/8 1-3/4	HC-32-6 HC-32-8 HC-32-12 HC-32-16 HC-32-22 HC-32-28	39/64	7/32
.3125 to .4375	.6267 .6264	3/8 1/2 3/4 1 1-3/8 1-3/4 2-1/8	HC-40-6 HC-40-8 HC-40-12 HC-40-16 HC-40-22 HC-40-28 HC-40-34	51/64	7/32
.3750 to .5312	.7518 .7515	1/2 3/4 1 1-3/8 1-3/4 2-1/8	HC-48-8 HC-48-12 HC-48-16 HC-48-22 HC-48-28 HC-48-34	59/64	7/32
.5000 to .6250	.8768 .8765	1/2 3/4 1 1-3/8 1-3/4 2-1/8	HC-56-8 HC-56-12 HC-56-16 HC-56-22 HC-56-28 HC-56-34	1-7/64	1/4
.6250 to .7500	1.0018 1.0015	1/2 3/4 1 1-3/8 1-3/4 2-1/8 2-1/2	HC-64-8 HC-64-12 HC-64-16 HC-64-22 HC-64-28 HC-64-34 HC-64-40	1-15/64	5/16
.7500 to 1.0000	1.3772 1.3768	3/4 1 1-3/8 1-3/4 2-1/8 2-1/2	HC-88-12 HC-88-16 HC-88-22 HC-88-28 HC-88-34 HC-88-40	1-39/64	3/8

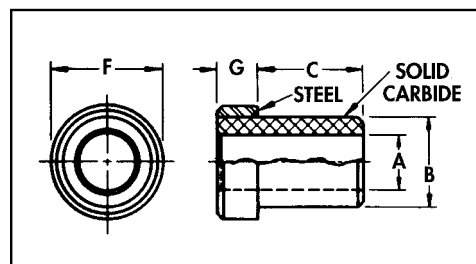

**SOLID CARBIDE SLIP  
& FIXED RENEWABLE BUSHINGS**

**ALSO AVAILABLE**

**PRICES UPON REQUEST**

**STANDARD I.D. TOLERANCES**

Up to 1/4	Nominal +.0001/+.0004
Over 1/4 to 3/4	Nominal +.0001/+.0005
Over 3/4 to 1-1/2	Nominal +.0002/+.0006
Over 1-1/2 to 1-3/4	Nominal +.0003/+.0007

**AVAILABLE IN DRILL SIZES  
UP TO 1.750**

**PRICES ON REQUEST**

**WILLIAM T. HUTCHINSON CO.**

TOLL FREE 1-800-544-7934 • 453 LEHIGH AVENUE • UNION, NEW JERSEY 07083-7926

# STEEL FEELER GAGE STOCK

Thickness	Strips 1/2 x 12"	Coils 1/2 x 25'	Thickness	Strips 1/2 x 12"	Coils 1/2 x 25'
.001	\$2.92	\$64.71	.039	1.35	24.80
.0015	1.56	31.69	.040	1.35	24.80
.002	1.56	31.69	.041-.045	6.00	AVAILABLE IN .001 INCREMENTS — NOT AVAILABLE IN COIL
.0025	1.56	31.69	.046-.055	6.50	
.003	1.56	31.69	.056-.065	7.00	
.004	1.27	22.80	.066-.075	7.25	
.005	1.27	22.80	.076-.090	7.50	
.006	1.27	22.80	.091-.125	8.00	
.007	1.12	18.83			
.008	1.12	18.83			
.009	1.12	18.83			
.010	1.12	18.83			
.011	1.12	18.83			
.012	1.12	18.83			
.013	1.12	18.83			
.014	1.12	18.83			
.015	1.12	18.83			
.016	1.12	18.83			
.017	1.12	18.83			
.018	1.12	18.83			
.019	1.12	18.83			
.020	1.12	18.83			
.021	1.12	18.83			
.022	1.12	18.83			
.023	1.12	18.83			
.024	1.12	18.83			
.025	1.12	18.83			
.026	1.12	18.83			
.027	1.12	18.83			
.028	1.12	18.83			
.029	1.12	18.83			
.030	1.12	20.00			
.031	1.17	21.50			
.032	1.17	21.50			
.033	1.17	21.50			
.034	1.17	21.50			
.035	1.17	21.50			
.036	1.35	24.80			
.037	1.35	24.80			
.038	1.35	24.80			



TOLERANCE FOR  
.020 & LARGER =  $\pm$  .0005  
FOR .019 & SMALLER  
SEE PAGE 63

Steel gage stock is made from fine quality 1095 tempered spring steel and etched every six inches for positive identification.

Available in 1/2" wide (12.7 MM) twelve inch (300 MM) lengths or 25' (7.62 M) rolls

Additional sizes and materials available. Call for pricing and delivery.

Metric - Steel		
Thickness	Strips 12.7mm x 300 mm	Coils 12.7mm x 7.62m
.04mm	\$ 3.25	\$ 70.00
.05	3.00	65.00
.06	2.75	60.00
.07	2.50	55.00
.08	2.50	55.00
.09	2.35	50.00
.10	2.35	50.00
.15	2.25	47.50
.20	2.25	47.50
.25	2.25	47.50
.30	2.25	47.50
.35	2.25	47.50
.40	2.25	47.50
.45	2.25	47.50
.50	2.25	47.50
.55	2.30	48.50
.60	2.30	48.50
.65	2.30	48.50
.70	2.30	48.50
.75	2.30	48.50
.80	2.35	50.00
.85	2.35	50.00
.90	2.35	50.00
.95	2.35	50.00
1.00	2.35	50.00
1.50	7.50	—
2.00	8.00	—
2.50	8.50	—
3.00	8.50	—

## WILLIAM T. HUTCHINSON CO.

TOLL FREE 1-800-544-7934 • (908) 688-0533 • FAX (908) 688-8296 • ESTABLISHED 1927

[www.hssblanks.com](http://www.hssblanks.com)

# STAINLESS STEEL FEELER GAGE STOCK

STAINLESS STEEL GAGE STOCK IS TYPE 301 EXTRA FULL HARD OR HIGH YIELD, WITH A #1 ROUND EDGE. LIKE THE STEEL STOCK IT IS ETCHED EVERY SIX INCHES FOR POSITIVE IDENTIFICATION.

AVAILABLE IN 1/2" AND 1" WIDTHS, TWELVE INCH LENGTHS OR 25' ROLLS.

SPECIAL LENGTHS, WIDTHS AND THICKNESS ON REQUEST.

Thickness	STRIPS 1/2 x 12"	COILS 1/2 x 25'	STRIPS 1 x 12"	COILS 1 x 25'	TOLERANCE +/-
.0005	\$4.92	\$90.00	\$6.25	\$122.73	.00005
.001	3.86	75.00	5.79	103.50	.00012
.0015	2.46	55.00	3.68	84.00	.00012
.002	2.11	47.00	3.16	71.78	.00016
.0025	2.95	47.00	—	—	.00016
.003	2.11	47.00	3.16	71.78	.00020
.004	1.76	33.00	2.59	51.00	.00020
.005	1.76	33.00	2.59	51.00	.00024
.006	1.76	33.00	2.59	51.00	.00028
.007	1.76	33.00	2.59	51.00	.00028
.008	1.76	33.00	2.59	51.00	.00031
.009	1.76	33.00	2.59	51.00	.00031
.010	1.76	33.00	2.59	51.00	.00035
.011	1.76	37.00	Not Available in Coils		.00035
.012	1.76	37.00			.00035
.013	1.76	37.00			.00043
.014	1.76	37.00			.00043
.015	1.76	37.00			.00043
.016	2.11	42.00			.00047
.017	2.11	42.00			.00047
.018	2.11	42.00			.00047
.019	2.11	42.00			.00047
.020	2.11	42.00			.00050
.021	2.46	47.00	.00050		
.022	2.46	47.00	.00050		
.023	2.46	47.00	.00050		
.024	2.46	47.00	.00050		
.025	2.46	47.00	.00050		
.031	2.46	47.00	.00050		

## WILLIAM T. HUTCHINSON CO.

TOLL FREE 1-800-544-7934 • 453 LEHIGH AVENUE • UNION, NEW JERSEY 07083-7926